

Rosca Whitworth, cone 60°

Rosca

D (mm)

d (mm)

Fios por
polegadas

| | | | |
|--------|-------|-------|----|
| 1/8" | 8,60 | 9,73 | 28 |
| 1/4" | 11,60 | 13,16 | 19 |
| 3/8" | 15,10 | 16,66 | 19 |
| 1/2" | 18,90 | 20,96 | 14 |
| 5/8" | 20,90 | 22,91 | 14 |
| 3/4" | 24,40 | 26,44 | 14 |
| 1" | 30,60 | 33,25 | 11 |
| 1-1/4" | 39,30 | 41,91 | 11 |
| 1-1/2" | 45,10 | 47,80 | 11 |
| 2" | 56,70 | 59,60 | 11 |



Rosca cônica ANSI, cone 60°

Rosca

d (mm)

Fios por polegadas

| | | |
|--------|-------|---------|
| 1/8" | 10,00 | 27 |
| 1/4" | 13,60 | 18 |
| 3/8" | 17,00 | 18 |
| 1/2" | 21,00 | 14 |
| 3/4" | 26 | 14 |
| 1" | 33,50 | 11-1/2" |
| 1.1/4" | 42,10 | 11-1/2" |
| 1.1/2" | 47,80 | 11-1/2" |
| 2" | 59,60 | 11-1/2" |



8434, rosca métrica, cone 24°

| Rosca | D (mm) | d (mm) | ØL tubo(mm) |
|---------|--------|--------|-------------|
| M10x1,0 | 9,0 | 10,0 | 4 |
| M12x1,5 | 10,5 | 12 | 6 |
| M14X1,5 | 12,5 | 14,0 | 8 |
| M16X1,5 | 14,5 | 16,0 | 10 |
| M18X1,5 | 16,5 | 18,0 | 12 |
| M20X1,5 | 18,5 | 20,0 | - |
| M22X1,5 | 20,5 | 22,0 | 15 |

| | | | |
|---------|------|------|----|
| M24X1,5 | 22,5 | 24,0 | - |
| M26X1,5 | 24,5 | 26,0 | 18 |
| M30X2,0 | 28,0 | 30,0 | 22 |
| M36X2,0 | 34,0 | 36,0 | 28 |
| M42X2,0 | 40,0 | 42,0 | - |
| M45X2,0 | 43,0 | 45,0 | 35 |
| M52X2,0 | 50,0 | 52,0 | 42 |

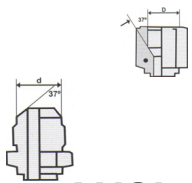

Rosca ANSI, chanfro 37°

| rosca | d (mm) | d (mm) | Fios por polegadas |
|---------|--------|--------|--------------------|
| 7/16" | 10,00 | 11,07 | 20 |
| 1/2" | 11,60 | 12,70 | 20 |
| 9/16" | 13,00 | 14,25 | 18 |
| 5/8" | 14,70 | 15,85 | 18 |
| 3/4" | 17,60 | 19,00 | 16 |
| 7/8" | 20,50 | 22,17 | 14 |
| 1-1/16" | 25,00 | 26,95 | 12 |
| 1-1/16" | 25,30 | 26,95 | 14 |

| | | | |
|---------|-------|-------|----|
| 1-3/16" | 27,95 | 30,12 | 12 |
| 1-5/16" | 31,30 | 33,30 | 12 |
| 1-5/8" | 39,20 | 41,22 | 12 |
| 1-7/8" | 45,60 | 47,57 | 12 |
| 2-1/2" | 61,50 | 63,45 | 12 |

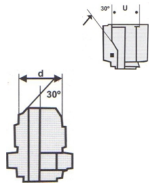

B 8363, rosca métrica, cone 60°

| Rosca | D (mm) | d (mm) | Passo (mm) |
|---------|--------|--------|------------|
| M14X1,5 | 12,50 | 14,00 | 1,5 |
| M16X1,5 | 14,50 | 16,00 | 1,5 |
| M18X1,5 | 16,50 | 18,00 | 1,5 |
| M22X1,5 | 20,50 | 22,00 | 1,5 |
| M24X1,5 | 22,50 | 24,00 | 1,5 |
| M30X1,5 | 28,50 | 30,00 | 1,5 |
| M33X1,5 | 31,50 | 33,00 | 1,5 |
| M42x1,5 | 40,50 | 42 | 1,5 |

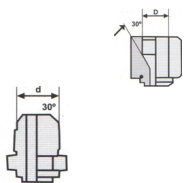

8363, rosca Whitworth, cone 60°

Tabela de Identificação de Roscas de Conexões Hidráulicas

| Rosca | D (mm) | d (mm) | Fios por polegada |
|--------|--------|--------|-------------------|
| 1/8" | 8,60 | 9,73 | 28 |
| 1/4" | 11,60 | 13,16 | 19 |
| 3/8" | 15,10 | 16,66 | 19 |
| 1/2" | 18,90 | 20,96 | 14 |
| 5/8" | 20,90 | 22,91 | 14 |
| 3/4" | 24,40 | 26,44 | 14 |
| 1" | 30,60 | 33,25 | 11 |
| 1-1/4" | 39,30 | 41,91 | 11 |
| 1-1/2" | 45,10 | 47,80 | 11 |
| 2" | 56,70 | 59,60 | 11 |

Rosca ANSI, face plana (macho com o'ring)

| rosca | d (mm) | D (mm) | Fios por polegadas |
|----------|--------|--------|--------------------|
| 9/16" | 12,70 | 14,28 | 18 |
| 11/16" | 15,87 | 17,46 | 16 |
| 13/16" | 19,05 | 20,63 | 16 |
| 1" | 23,81 | 25,40 | 14 |
| 1.3/16" | 27,78 | 30,16 | 12 |
| 1.7/16" | 34,13 | 36,51 | 12 |
| 1.11/16" | 40,48 | 42,86 | 12 |

2"

48,41

50,80

12

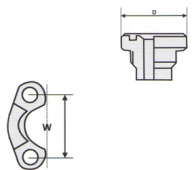

Fig 61 (3000 PSI) & 62 (6000 PSI)

DN

D (mm)

W (mm)

D (mm)

1/2"

code 61 - 3000 PSI
30,16

code 62 - 6000 PSI
38,10

31,75

3/4"

38,10

47,62

41,27

1"

44,45

52,38

47,62

1-1/4"

50,80

58,73

53,97

1-1/2"

60,32

69,85

63,50

2"

91,43

77,78

79,37